

VRLA - Sealed free maintenance

XMB 12-65X 12V/65AH (20h)

VRLA-AGM BATTERIES

Las baterías XMB conforman una familia de baterías de ácido plomo tipo VRLA de descarga profunda de excelente calidad, rendimiento extraordinario y un amplio rango de aplicaciones. Han sido diseñadas para cumplir con los más exigentes estándares mundiales de calidad, seguridad y rendimiento, usando tecnología punta. Son 100% libres de mantenimiento y selladas para una operación sin fugas. Usan tecnología AGM para una eficiente recombinación de gases hasta de 99%.

APLICACIONES PRINCIPALES

Telecom



Sistemas de Seguridad



Luminaria de Emergencia



Respaldo de Sistemas Críticos



UPS/SAI



Inversores AC/DC



CARACTERÍSTICAS

- Baterías selladas de libre mantenimiento
- Separadores AGM y placas planas
- Opciones en terminales de conexión
- Caja de ABS de alto impacto
- Recarga rápida
- Auto descarga inferior al 3.5%/mes

VENTAJAS

- Temperatura de operación: -15 to +50°C
- Tiempo de vida: 5 a 12 años (@ 20°C)
- Tiempo de vida en cantidad de ciclos:
 - > 1500 ciclos a 30% DOD
 - > 600 ciclos a 50% DOD
 - > 300 ciclos a 100% DOD
- Alto rendimiento a bajas temperaturas

VRLA - SEALED FREE MAINTENANCE BATTERY 12V/65AH (20h)

Xmart
by Integra

TECHNICAL SPECIFICATIONS / Especificaciones Técnicas

Nominal Voltage	12V	
Nominal Capacity (10hr)	65.0AH	
Dimension	Lenght	348 +/- 2mm
	Width	167 +/- 2mm
	Container Height	178 +/- 2mm
	Total Height (with terminals)	178 +/- 2mm
Approx Weight	Approx. 19.2 Kg	
Terminal	T6	
Container Material	ABS	
Rated Capacity	65.0 AH / 3.25A	(20hr, 1.80V/cell, 25°C/77°F)
	62.1 AH / 6.21A	(10hr, 1.80V/cell, 25°C/77°F)
	53.6 AH / 10.72A	(5hr, 1.75V/cell, 25°C/77°F)
	45.8 AH / 15.30A	(3hr, 1.75V/cell, 25°C/77°F)
	37.5 AH / 37.5A	(1hr, 1.60V/cell, 25°C/77°F)
Max. Discharge Current	780A (5s)	
Internal Resistance	Approx. 7.3 mili Ohm	
Operating Temperature Range	Discharge:	-15°C to 50°C (5 to 122°F)
	Charge:	0°C to 40°C (32 to 104°F)
	Storage:	-15°C to 40°C (5 to 104°F)
Normal Operating Temp. Range	25°C +/- 3°C (77°F +/- 5°F)	
Cycle Use	Initial Charging Current less than 19.5 A.	
	Voltage 14.4V-15.0V at 25°C. Temp coefficient -30mV/°C	
Standby Use	No limit on initial charging current voltage	
	13.5V - 13.8V at 25°C (77°F) Temp. coefficient -20mV/°C	
Capacity affected by Temperature	40°C (104°F)	103%
	25°C (77°F)	100%
	0°C (32°F)	86%



Aplicaciones

UPS
Inversores AC/DC
Luminaria de emergencia
Sistemas de comunicación
Fuentes DC
Equipos electrónicos
Sistemas de respaldo en general

TERMINAL T6 / Terminal T6

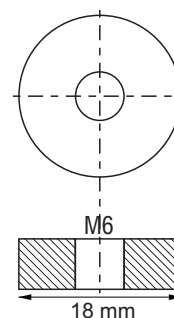

DIMENSIONS / Dimensiones

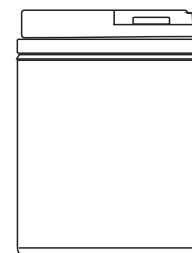
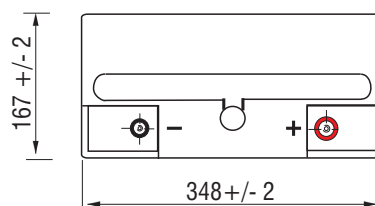
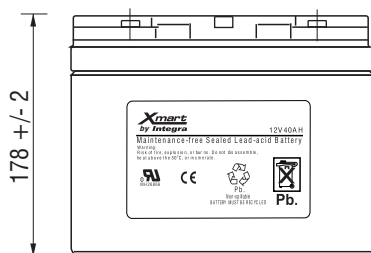

* VRLA: Valve Regulated Lead Acid / * AGM: Absorbent Glass Material

12-65AH: P2

VRLA - SEALED FREE MAINTENANCE BATTERY 12V - 65AH (10h)



CONSTANT DISCHARGE / Descarga Constante (Amps at 25°C)

F.V/Time	5min	10min	15min	20min	30min	45min	1h	2h	3h	4h	5h	6h	8h	10h	20h
1.85V/cell	114.0	87.6	75.5	65.6	50.8	37.8	30.6	18.5	14.2	11.78	10.04	8.79	7.11	5.98	3.20
1.80V/cell	142.7	102.5	85.9	73.8	55.7	40.8	32.7	19.7	14.9	12.34	10.47	9.16	7.40	6.21	3.25
1.75V/cell	160.9	111.8	93.8	79.0	58.7	42.8	34.2	20.4	15.3	12.65	10.72	9.35	7.51	6.27	3.29
1.70V/cell	177.1	120.7	100.1	82.9	61.4	44.3	35.6	21.1	15.8	12.96	10.97	9.53	7.62	6.33	3.32
1.65V/cell	193.8	130.0	105.1	86.1	63.3	45.8	36.6	21.6	16.2	13.23	11.18	9.70	7.73	6.40	3.37
1.60V/cell	210.1	138.2	109.3	89.4	65.0	47.4	37.5	22.1	16.6	13.49	11.38	9.84	7.83	6.48	3.38

CONSTANT DISCHARGE / Descarga Constante (Watts at 25°C)

F.V/Time	5min	10min	15min	20min	30min	45min	1h	2h	3h	4h	5h	6h	8h	10h	20h
1.85V/cell	208.5	161.7	140.9	123.6	96.8	72.7	59.1	35.9	27.7	23.0	19.7	17.28	14.04	11.83	6.34
1.80V/cell	258.1	187.0	158.1	137.0	104.6	77.9	62.8	37.9	29.0	24.0	20.4	17.93	14.56	12.27	6.43
1.75V/cell	284.8	200.8	170.5	145.3	109.3	80.9	65.3	39.3	29.6	24.5	20.9	18.24	14.74	12.38	6.50
1.70V/cell	304.9	211.9	179.5	151.4	113.6	83.4	67.7	40.4	30.4	25.1	21.3	18.58	14.94	12.49	6.56
1.65V/cell	328.8	226.2	186.9	156.0	116.3	85.4	69.1	41.2	31.1	25.5	21.6	18.84	15.13	12.61	6.64
1.60V/cell	348.4	235.0	191.2	160.3	118.4	87.9	70.5	41.9	31.6	25.9	21.9	19.07	15.30	12.74	6.66

DISCHARGE CURVES / Curvas de Descarga

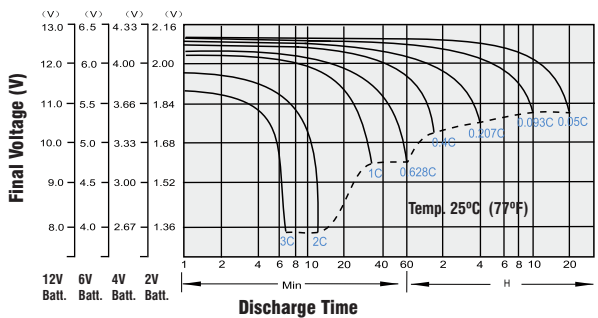

RECHARGING / Recarga

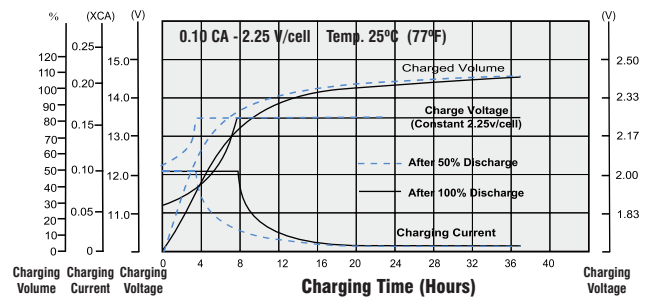

CAPACITY Vs. TEMP. / Capacidad Vs. Temp.

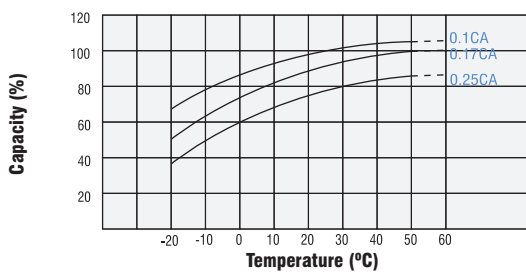

LIFE EXPECTANCY Vs. TEMP. / Vida Vs. Temp.

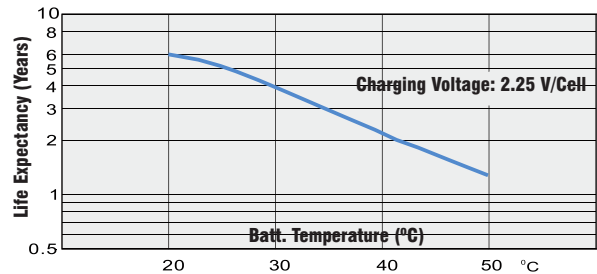

DISCHARGING CYCLES / Vida Vs. Descargas

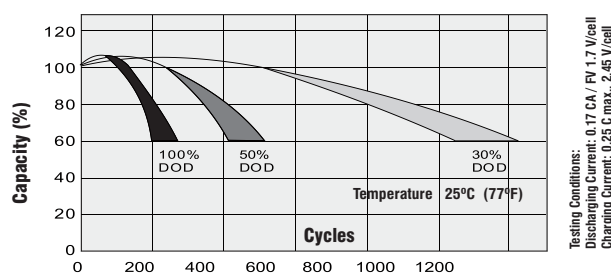

Testing Conditions:
Discharging Current: 0.17 CA / FV 1.7 V/cell
Charging Current: 0.25 C max., 2.45 V/cell

STORAGE TIME / Tiempo de Almacenaje

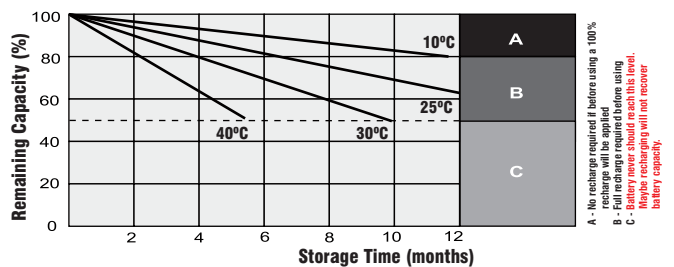

A - No recharge required if before using at 100%
B - Full recharge required before using
C - Battery never should reach this level.
Maybe recharging will not recover battery capacity.